

In case of incorrect or doubtful translation, only the Italian text applies (Translation of the original instructions).



The equipment must be installed only by a specialised technician!

Read and apply that referred to the following pages before carrying out the installation.
Keep this manual in a safe place.

Dear Customer,

the product you have purchased is an helical fan for window or wall installation. To ensure optimum operation and guarantee a long life, read this manual carefully that explains how to effectuate a correct installation and to use and maintain the product properly. Following all the instructions ensures reliability and long life, both mechanically and electrically.

The manufacturer declines any responsibility for damages caused to persons or things deriving from the lack of observance of the following described instructions.

The product is constructed using state of the art technology and respects the standards in force regarding electrical equipment. It conforms with the EMC 2014/30/EU European Directive regarding radio interference suppression and electro-magnetic compatibility.

Installation and usage instructions



WARNING: Serious injury or death can be caused if these instructions are not applied!

- Do not use this product for uses that are different from those for which it has been designed.
- After removing the product from its packaging ensure that it is complete and undamaged; if in doubt, immediately contact a qualified electrician.
- Do not leave parts of the packaging within reach of children or incompetent persons. To dispose of the packaging and the appliance at the end of its useful life refer to the recycling norms in force in your country.
- Immediately contact a qualified person (authorised dealer or the manufacturer) if the product is dropped or knocked to check its correct functioning.
- Do not touch the appliance with wet or humid parts of the body (e.g., hands or feet).
- This appliance can be used by children aged from 8 years and above and persons with reduced physical, sensory or mental capabilities or lack of experience and knowledge if they have been given supervision or instruction concerning use of the appliance in a safe way and understand the hazards involved. Children shall not play with the appliance. Cleaning and user maintenance shall not be made by children without supervision.
- The means of disconnection from the supply mains must have a contact separation in all poles and must provide full disconnection under overvoltage category III conditions.
- If there is a combustible-fed device (water heater, gas boiler, etc. of the sealed chamber type) in the room where the product is to be installed check that the re-circulation of air is sufficient to ensure a good combustion for the correct functioning of these devices, precautions must be taken to avoid the back-flow of gases into the room from the open flue of gas or other fuel-burning appliances.
- To avoid the risk of fire do not using the product in the presence of inflammable substances and vapours, such as alcohol, insecticides, petrol, etc.
- The product can be connected to the supply mains only if the voltage and the frequency of the supply mains correspond to those written in the rating label.
- In the case of malfunction, anomaly or any type of fault disconnect the appliance from the electrical main supply and contact a qualified person. Use only original spare parts for repairs.
- The electrical system to which the appliance is connected must conform with the local norms in force regarding electrical systems.
- The appliance must not be used to activate water heaters, room heaters, etc.
- It is forbidden for the appliance to discharge air into hot air ducts used for the evacuation of fumes coming from the combustion of stoves or other combustion devices. It

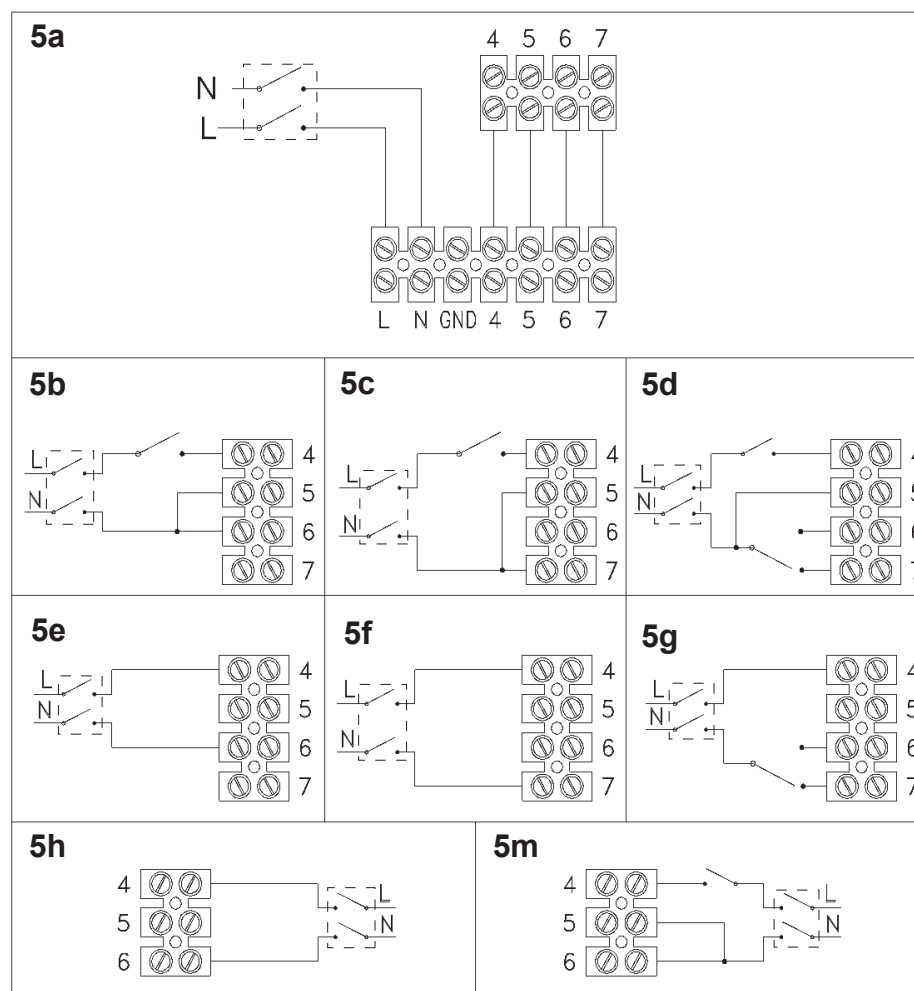

LEGEND FIG. 5

- Fig. 5a = Connection with speed controller for models 9/230 and 12/300
 Fig. 5b = Connection for models 9/230 and 12/300 automatic for extraction only (make a bridge between 5 and 6)
 Fig. 5c = Connection for models 9/230 and 12/300 automatic for intake only (make a bridge between 5 and 7)
 Fig. 5d = Connection for models 9/230 and 12/300 automatic with reversibility switch (make a bridge between 5 and supply)
 Fig. 5e = Connection for models 9/230 manual for extraction only
 Fig. 5f = Connection for models 9/230 manual for intake only
 Fig. 5g = Connection for models 9/230 manual with reversibility switch
 Fig. 5h = Connection for models 6/150 manual
 Fig. 5m = Connection for models 6/150 automatic (make a bridge between 5 and 6)
 Fig. 5n = Dismantling of the terminal block for the models 9/230 and 12/300

DISMANTLING AND RECYCLING



The product has been designed and constructed using high-quality materials and components that can be recycled or re-utilised.

If a crossed-out wheeled bin is illustrated on a product, this means that the product satisfies the requirements of the 2012/19/

EU European Directive.

Make inquiries about the disposal collection methods of electrical and electronic products in force in the zone in which the product must be disposed of.

Conform to the local norms regarding the disposal of waste materials and do not dispose of old products in normal domestic waste material. A correct dismantling and disposal of products helps to prevent environmental pollution and possible injury to health.

Abusive disposal of the product by the user implies the application of administrative fines foreseen by the norms in force.

must discharge directly outside the building.

! WARNING: Damage can be caused to the device if the following instructions are not applied!

- Do not use the product at environmental temperatures more than 40°C.
- Do not leave the appliance exposed to atmospheric agents (rain, sun, snow, etc.). The possible applications of this product are illustrated in this manual.
- Do not immerse the appliance or parts of it in water or any other liquids.
- When cleaning or carrying out ordinary maintenance, check the integrity of the appliance.
- The flow of air or fumes that is conveyed by the appliance must be clean and free of greasy elements, soot, chemical/corrosive agents and inflammable or explosive mixtures.
- Do not obstruct the air inlet and outlet of the appliance in any way whatsoever. When using air ducting make sure that the ducting is not blocked.
- It is recommended to install it at a minimum height of 2.30 metres from the floor.
- For an optimum functioning of the appliance, it is necessary to ensure an adequate re-circulation of air in the room. Consult the local norms with regards to this.

INSTALLATION

PLEASE REFER TO THE NUMBERING INDICATED IN INCREASING ORDER (NOT ADJOINING), TO DISMANTLE THE FAN.

Installation in single glazed window (Fig. 1): dismantle the fan into its various components as shown and reassemble it on the window as shown in Fig. 1.

Installation into double glazed windows (Fig. 1 and Fig. 1A): refer to Fig. 1 for dismantling and reassembling the fan. If necessary use the double-glazing kit, inserting the rings as shown in Fig. 1A.

Installation into double windows (Fig. 2): dismantle and reassemble the fan as shown in Fig. 2 using the double window kit.

Installation into walls (Fig. 3 and Fig. 4): wall installation can be carried out using two different methods:
- by using wall rods in those instances where there is no direct access to the outside (Fig. 3).
- by using wall plugs if there is easy access to the outside (Fig. 4).

See Fig. 5 for all electrical connections.

See Fig. 5n for information on dismantling the terminal block in models 9/230 and 12/300.

OPERATION

Manual version: pulling the cord opens the shutters and the fan operates. Pulling the cord a second time closes the shutters and stops the fan.

Automatic version: the fan is operated by the control switch. A neon light on the fan shows that the fan is operating. The shutters on these fans are of the delayed action type and will take several seconds both to open and close. Some models are provided with a speed controller. When the speed controller is set at “0” the shutters on the fan will stay open even though the motor is not operating (the neon light is on).

MAINTENANCE AND CLEANING

Before carrying out any maintenance or cleaning operations, disconnect the mains electrical supply.

- Remove the front cover with reference to the type of installation carried out.
- Clean the front cover with water or a mild detergent.
- Disconnect the fan from the supply cable, before dismantling the motor holder from the body (for models 9/230 and 12/300 only).
- The motor-fan assembly should be cleaned only with a dry brush or dry cloth.
- During cleaning operations, ensure that the motor-fan assembly does not come into contact with any type of liquid or solvent. If this should occur, contact a qualified technician before reassembling the fan.

TROUBLE SHOOTING

PROBLEM	CAUSE AND REMEDY
The appliance does not switch on	There is no voltage. Check the main switch and/or the electrical connections.
The impeller does not turn	Check that its movement is not slowed down.
Automatic models: if the shutters remain open and the neon light is on, but the motor is not running	Where a speed controller is used check to see that it is not set at “0”.

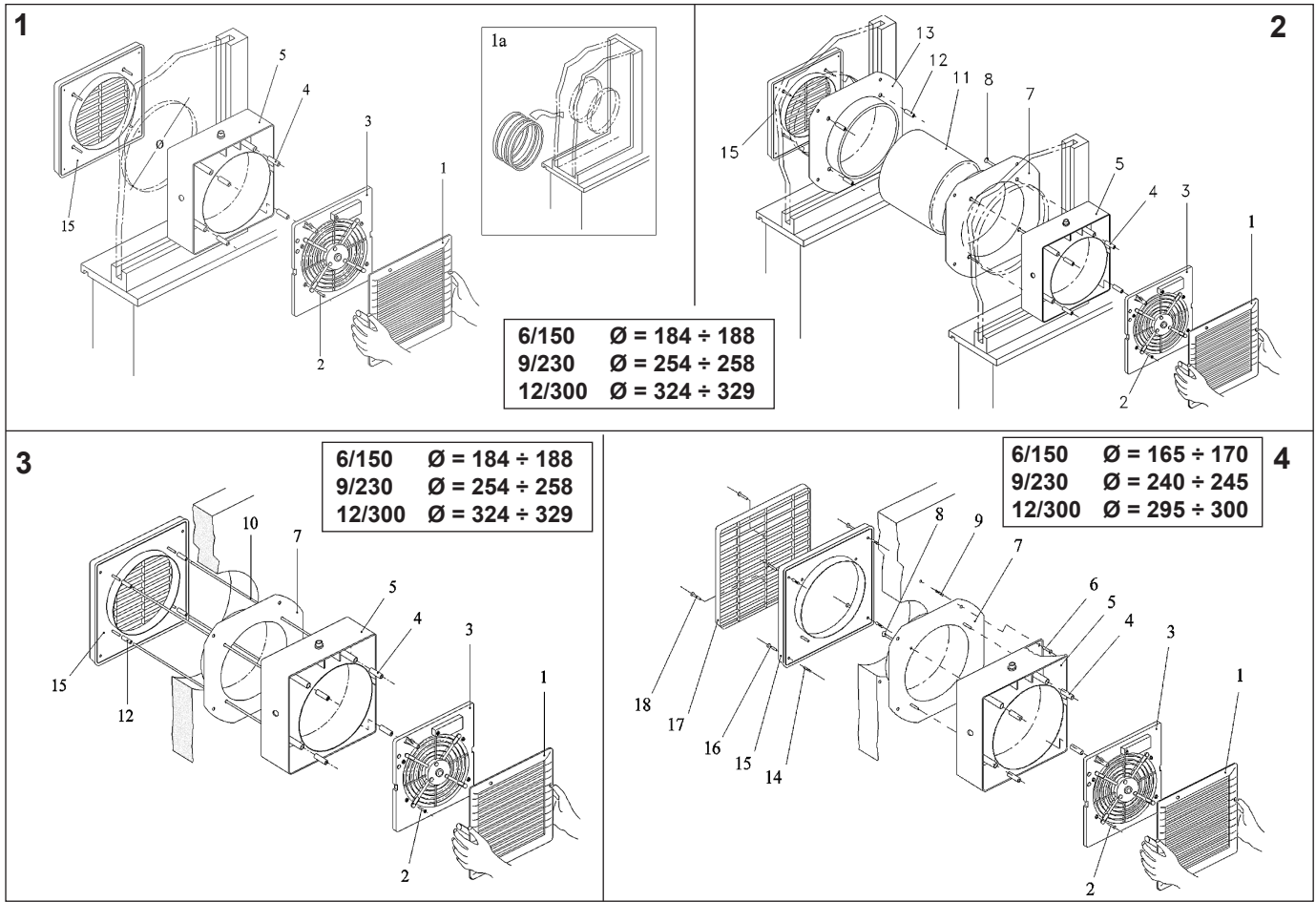

LEGEND FIG. 1-2-3-4

- | | | |
|-----------------------------|-------------------------|--------------------------|
| 1. Front | 8. Flange fixing screws | 15. Grille holder |
| 2. Plate disassembly screws | 9. Wall plugs | 16. Wall-fixing screws |
| 3. Motor-holder plate | 10. Wall rods | 17. External grille |
| 4. Bushes (sleeves) | 11. Shell | 18. Grille fixing screws |
| 5. Intermediate body | 12. Bushes (sleeves) | |
| 6. Wall-fixing screws | 13. Flange | |
| 7. Flange | 14. Wall plugs | |

5n

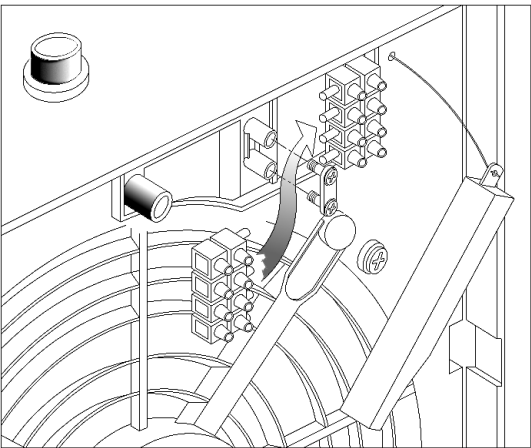

6

